



WATERPROOFING

COLPHENE H[®]

ROOFS

ROOFS

PLAZA DECKS

MONOLITHIC RUBBERIZED-BITUMEN WATERPROOFING MEMBRANE

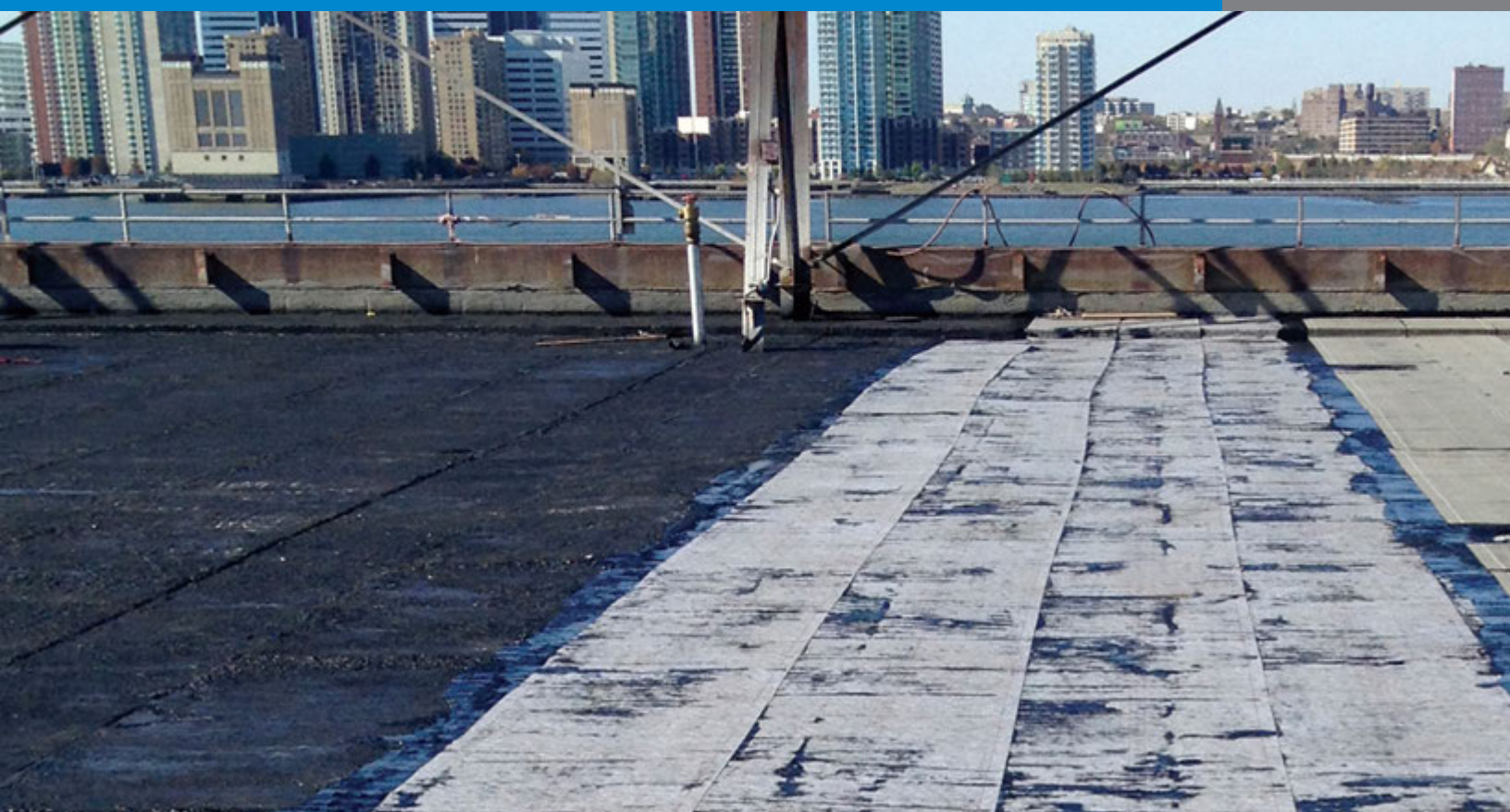



COLPHENE H[®]

MONOLITHIC RUBBERIZED-BITUMEN WATERPROOFING MEMBRANE

The COLPHENE H membrane is composed of hot-rubberized bitumen reinforced with SBS and mineral fillers. It is a liquid-applied system used in conjunction with a reinforcing fabric to ensure proper waterproofing of concrete structures.

When used with SOPRA-XPS extruded polystyrene insulation, COLPHENE H membrane allows the design of a sustainable, high-performance inverted roof assembly.

MAIN BENEFITS OF COLPHENE H MEMBRANE

- It can be applied in all seasons, even in very cold weather (down to -18 °C).
- It has 100% solids content, which allows it to harden quickly.
- It keeps its elastomeric properties in both hot and cold weather.

MULTIPLE APPLICATIONS

COLPHENE H membrane can be used in protected membrane roof systems (inverted roofs), SOPRANATURE vegetated systems and plaza decks, bridges, foundations and other types of below-grade walls.

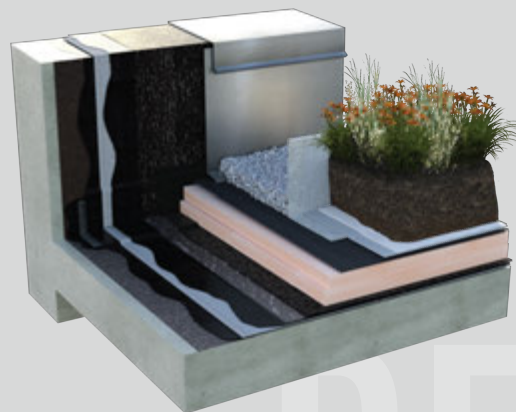
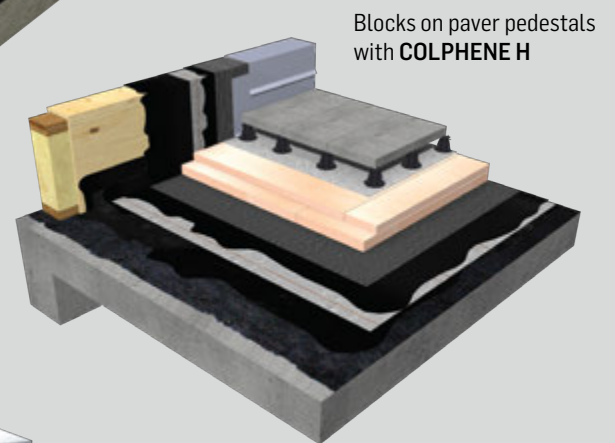
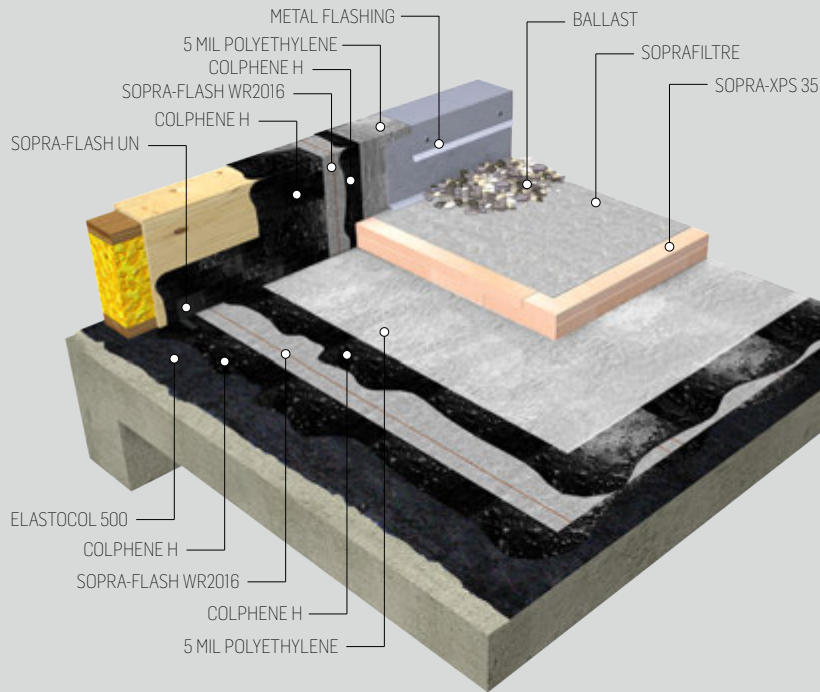

Vegetated system with **COLPHENE H**

PEACE
OF MIND

INSTALLATION STEPS

- Prime the clean cured concrete surface with ELASTOCOL 500.
- Apply a coat of COLPHENE H membrane.
- Unroll the SOPRA-FLASH WR reinforcement or other SOPREMA-approved materials.
- Unroll SOPRA-FLASH UN uncured neoprene membrane or other SOPREMA-approved materials at transitions and around drains and other penetrations.
- Apply a second layer of COLPHENE H monolithic membrane.
- Unroll a polyethylene separation sheet or SOPRABOARD, SOPRADRAIN, ELASTOPHENE SANDED sheet or other SOPREMA-approved materials.
- Lay the SOPRA-XPS extruded polystyrene insulation.
- Lay the SOPRAFILTRE geotextile.



The positioning of the drainage and insulation panels as well as the type and weight of ballast used to hold the insulation in place must also be considered.

Contact your SOPREMA representative to help you with your projects.

SOPREMA WARRANTIES

Whether for a new project, refurbishment work or the installation of a SOPRANATURE system, the MAMMOUTH PLATINUM warranties are among the most advantageous in the industry.

They are non-regressive and provide comprehensive protection against any manufacturing or installation defect causing leakage. Depending on your needs and the membranes selected, MAMMOUTH PLATINUM warranties are valid for a period of 10, 15 or 20 years.

SOPREMA IN CANADA



12 
production
units

9 
training
centres

Over
70 
technicians
and technical
representatives

A research centre
located in
Drummondville
with twenty full-time
workers



INNOVATION SINCE 1908

SOPREMA developed around the idea that the quality, durability and reliability of materials must match builders' ambitions and expectations. For more than 100 years, SOPREMA has been using its expertise to develop a variety of high-end products that meet or exceed all the requirements of the construction field.

SOPREMA holds over a century of expertise in the field of polymer-modified bitumen technology.

ROOFS **WALLS** **FOUNDATIONS** **PARKING DECKS** **BRIDGES** **ADDITIONAL EXPERTISE**



WATERPROOFING



INSULATION



VEGETATIVE SOLUTIONS



SOUNDPROOFING



ACCESSORY PRODUCTS

SOPREMA is an international manufacturer specializing in the production of waterproofing and insulation products, as well as vegetative and soundproofing solutions, for the building and civil engineering sectors.

SOPREMA.CA

1.877.MAMMOUTH
