

## FIBROUS COATING

### COATING

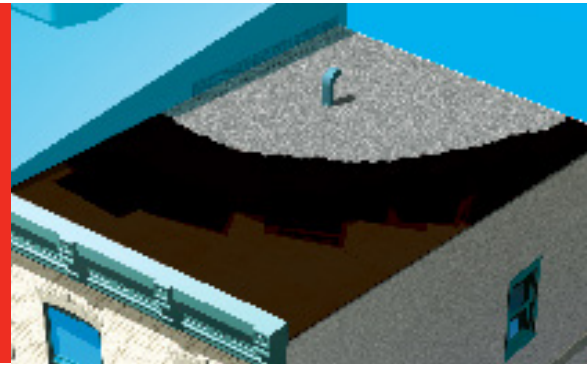

Bitumen based coating for built-up roofs, mineral fillers and cellulose fibers that allow the product to be applied on slightly sloped roofs. It is completely waterproof and works with various roof elements (chimneys, metal flashing, etc.).

- Extends the useful life of built-up roofs
- Adheres to many types of materials without primer
- Dries quickly

#### PRODUCT PURPOSE

Application	Waterproofing
Building Part	Roofing
Types of Slope	Low slope
Substrate	Asphalt roof

#### PRODUCT CHARACTERISTICS

Technology	SBS modified bitumen	
Installation Method	Brush	Scraper
	Roller	
Operating Temperature	-40 °C to 80 °C (-40 °F to 176 °F)	

#### PACKAGING

Code	Containers	Indicative covering	Quantity per pallet
53030	3.78 l (1 US gal)	2 to 3 l /m <sup>2</sup> (0.5 to 0.8 US gal/10 ft <sup>2</sup> )	120
53031	18.9 l (5 US gal)		36



#### PROPERTIES

Properties	FIBROUS COATING
Color	Black
Specific gravity at 20 °C (68 °F)	1.06 kg/L (8.85 lbs/US gal)
Flow	None at these temperatures
Ultimate elongation	25%

All values are nominal)

## FIBROUS COATING

### INSTALLATION

Storage	24 months in its original closed packaging, in a cool, well-ventilated area. Store in a cool, dry place up to 40 °C (104 °F). The product can withstand freezing.	
Minimum Application Temperature	10 °C (50 °F)	
Complementary products	PLASTIC CEMENT	BLACK ELASTOMERIC SEALER
Tools required	 Brush	 Roller
	 Squeegee / Trowel	
Installation Prerequisite	The substrate must be clean, dry and free of dust, grease or other contaminants.	
Installation	<ol style="list-style-type: none"> <li>1. Repair holes and cracks with plastic cement or an elastomer sealant before applying the coating.</li> <li>2. Pour the product on the roof and spread evenly using a brush, scraper or roller.</li> <li>3. When the coating is dry, cover with gravel to protect the surface from UV rays.</li> </ol>	
Drying time	Between 24 and 48 hours, depending on ambient temperature and the amount applied.	
Cleaning	Clean tools with petroleum solvents (mineral spirits, xylene, etc.).	
Tricks / Tips	The protection offered by the FIBROUS COATING will have an optimal duration if protected from UV rays, for example using gravel.	
Recommendations/ Limitations	Use is not recommended on elastomer bitumen membranes, asphalt shingles, coal tar pitch and metal roofs. It is not recommended to use a product containing bitumen directly on softwood boards or on flexible polyvinyl chloride. Do not use on asphaltic shingles if roof slope is above 6/12.	
Warnings	Keep out of the reach of children. Properly close the container after each use. During use, keep away from ignition sources. No smoking. After application, keep away from flames until solvent has evaporated. Do not pour residues in drains.	