

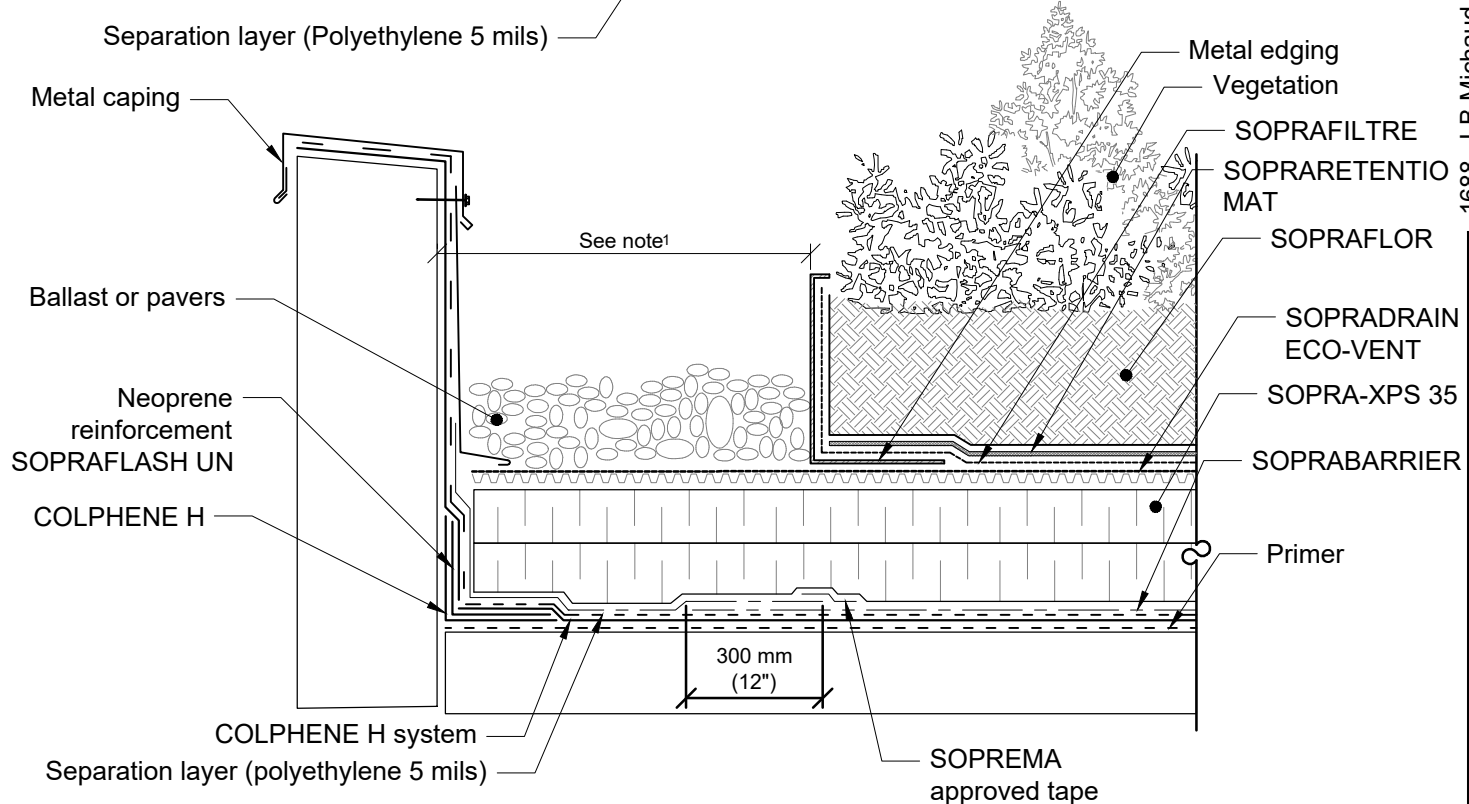

1688, J-B Michaud Drummondville, QC J2C 8E5 WWW.SOPREMA.CA

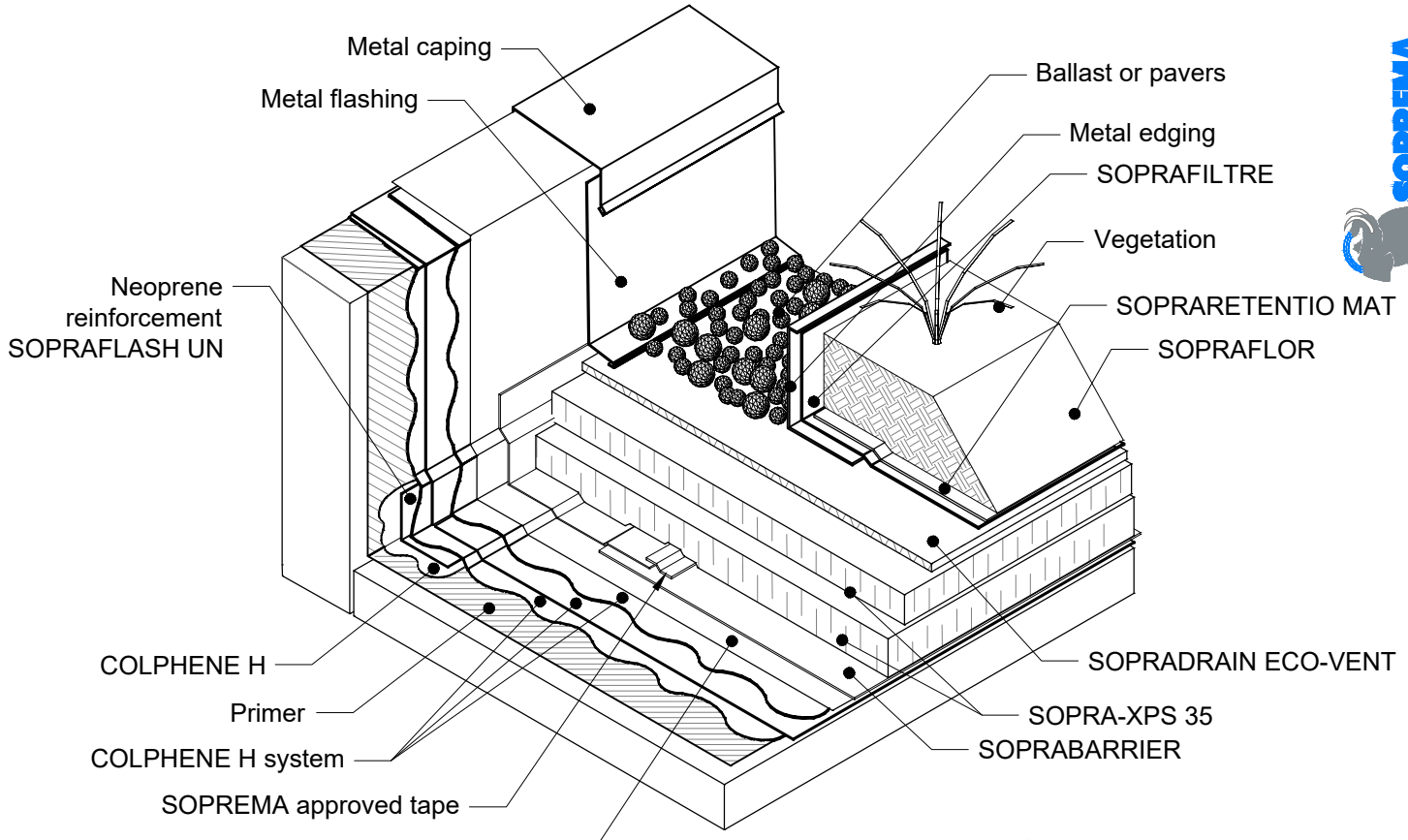

Note¹: Provide vegetation-free zone at the base of upstands, around drains and roof projections as per applicable standards.

COPYRIGHT 2018 SOPREMA

Title:
PARAPET DETAIL - INTENSIVE SYSTEM - HOT RUBBERIEZED ASPHALT

| | | |
|------------------|--------------------|------------------------------|
| Scale: N.T.S. | Date: Nov. 2018 | Drawing number: SOP220-01 |
|------------------|--------------------|------------------------------|