

# TECHNICAL DETAILS

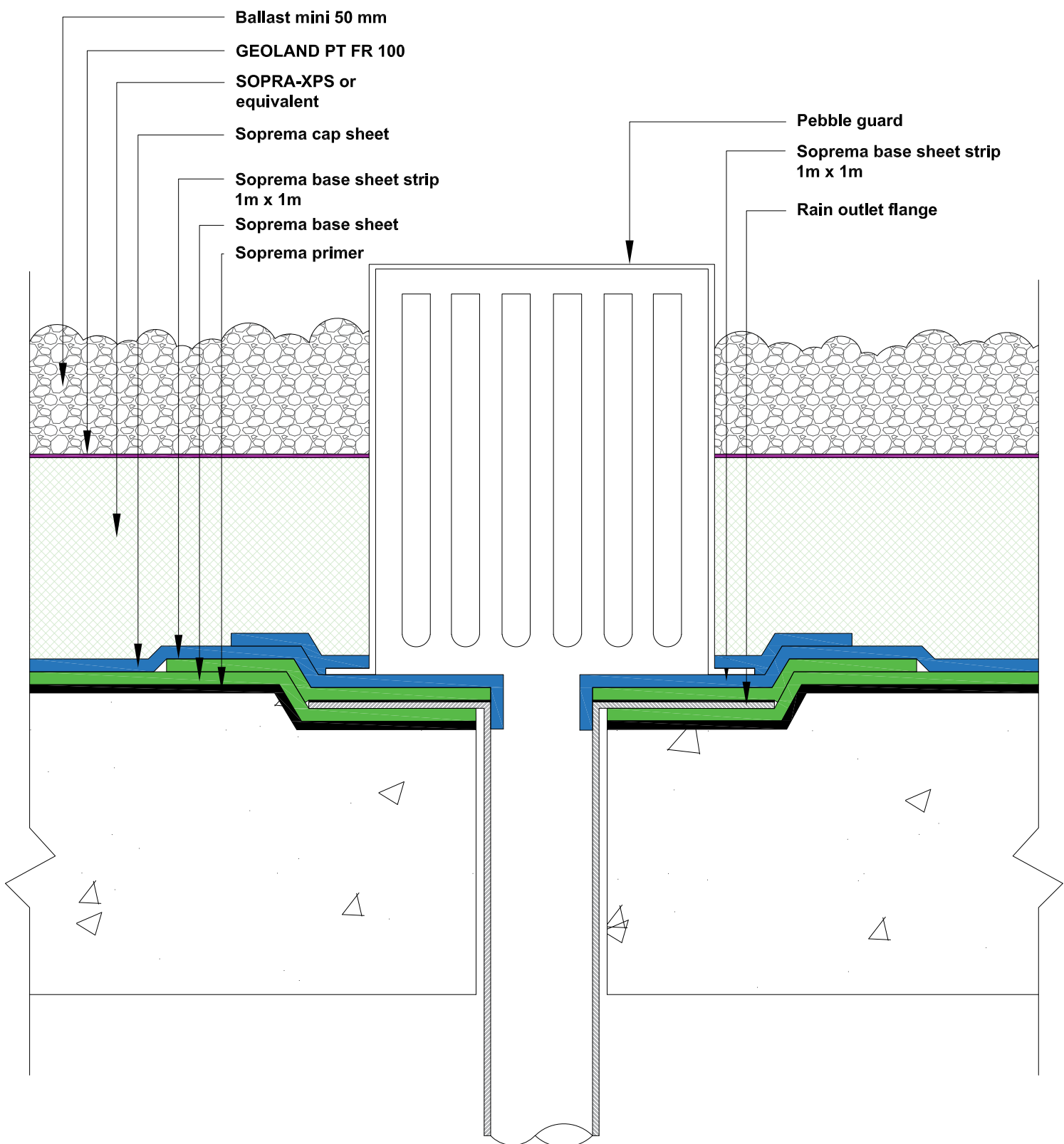

## Bituminous Roofs **TWO-LAYER INVERTED INSULATION**

[soprema.com.au](http://soprema.com.au)



COPYRIGHT 2021 SOPREMA



**SOPREMA**

LEVEL 35, BARANGAROO  
AVENUE, SYDNEY, 2000  
WWW.SOPREMA.COM.AU

TITLE:

**RAIN OUTLET DETAIL**

PROJECT:

DRAWING NUMBER:

SCALE:

NTS

DATE:

2021

IR3

**NOTE:**

This detail is only indicative and should be verified by the designer and/or the applicator according to real job site conditions.

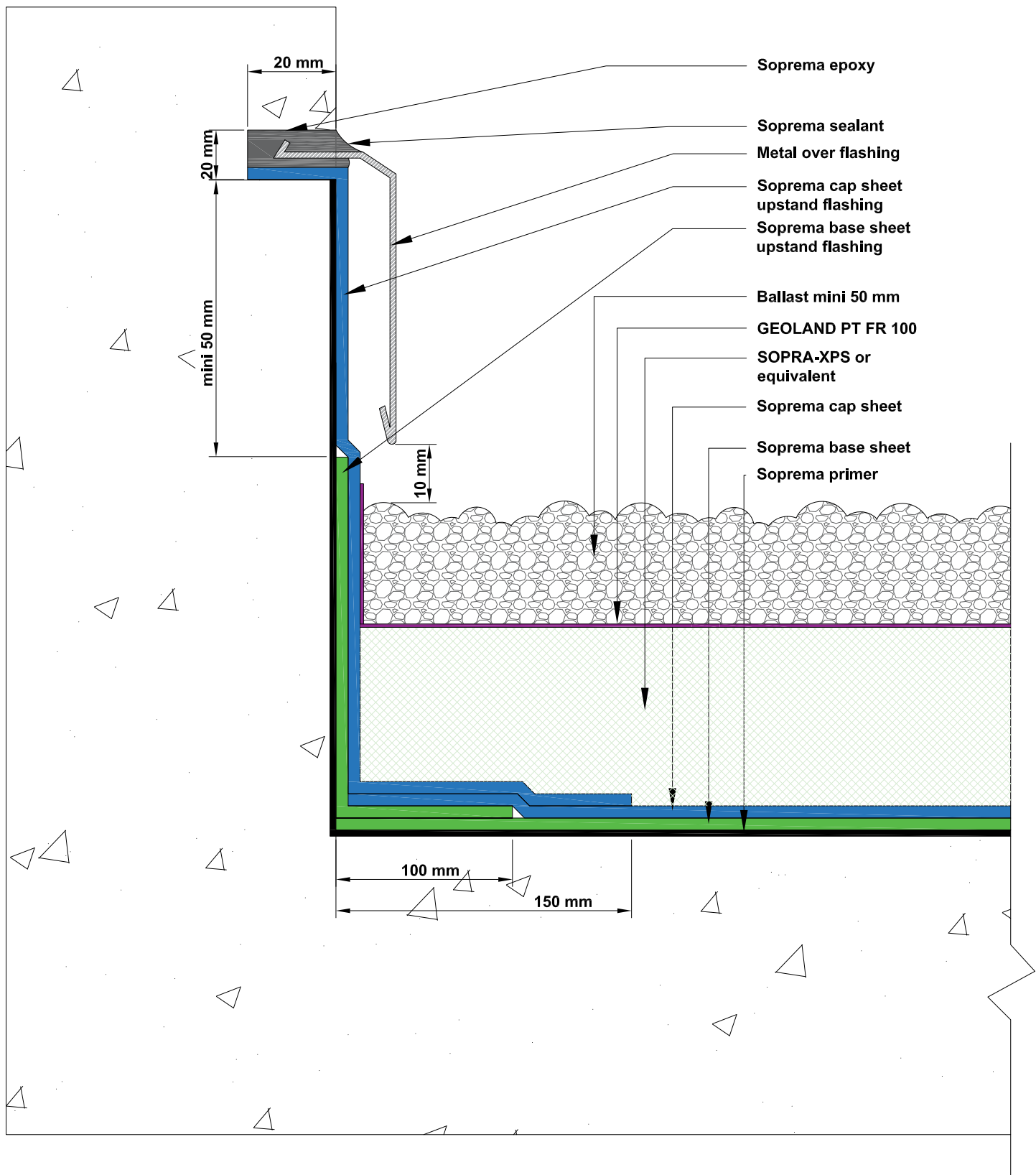

COPYRIGHT 2021 SOPREMA



**SOPREMA**

LEVEL 35, BARANGAROO  
AVENUE, SYDNEY, 2000  
WWW.SOPREMA.COM.AU

TITLE: UP-STAND DETAIL WITH TERMINATION  
INTO A CHASE

PROJECT:

DRAWING NUMBER:

SCALE:

NTS

DATE:

2021

IR5

**NOTE:**

This detail is only indicative and should be verified by the designer and/or the applicator according to real job site conditions.

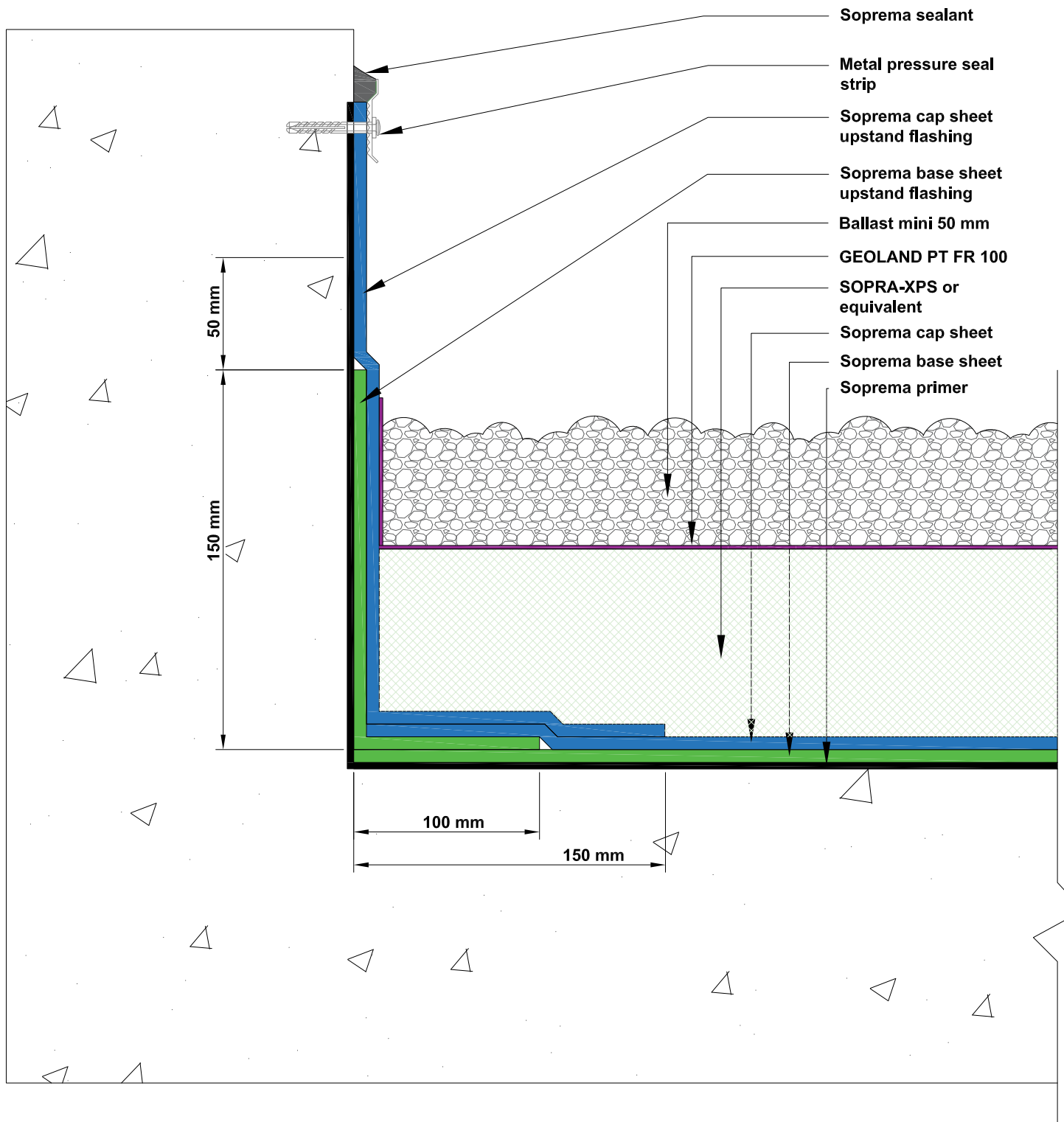

COPYRIGHT 2021 SOPREMA



**SOPREMA**

LEVEL 35, BARANGAROO  
AVENUE, SYDNEY, 2000  
WWW.SOPREMA.COM.AU

TITLE: **UP-STAND DETAIL WITH PRESSURE  
SEAL TERMINATION STRIP**

PROJECT:

DRAWING NUMBER:

SCALE:

NTS

DATE:

2021

IR6

**NOTE:**

This detail is only indicative and should be verified by the designer and/or the applicator according to real job site conditions.

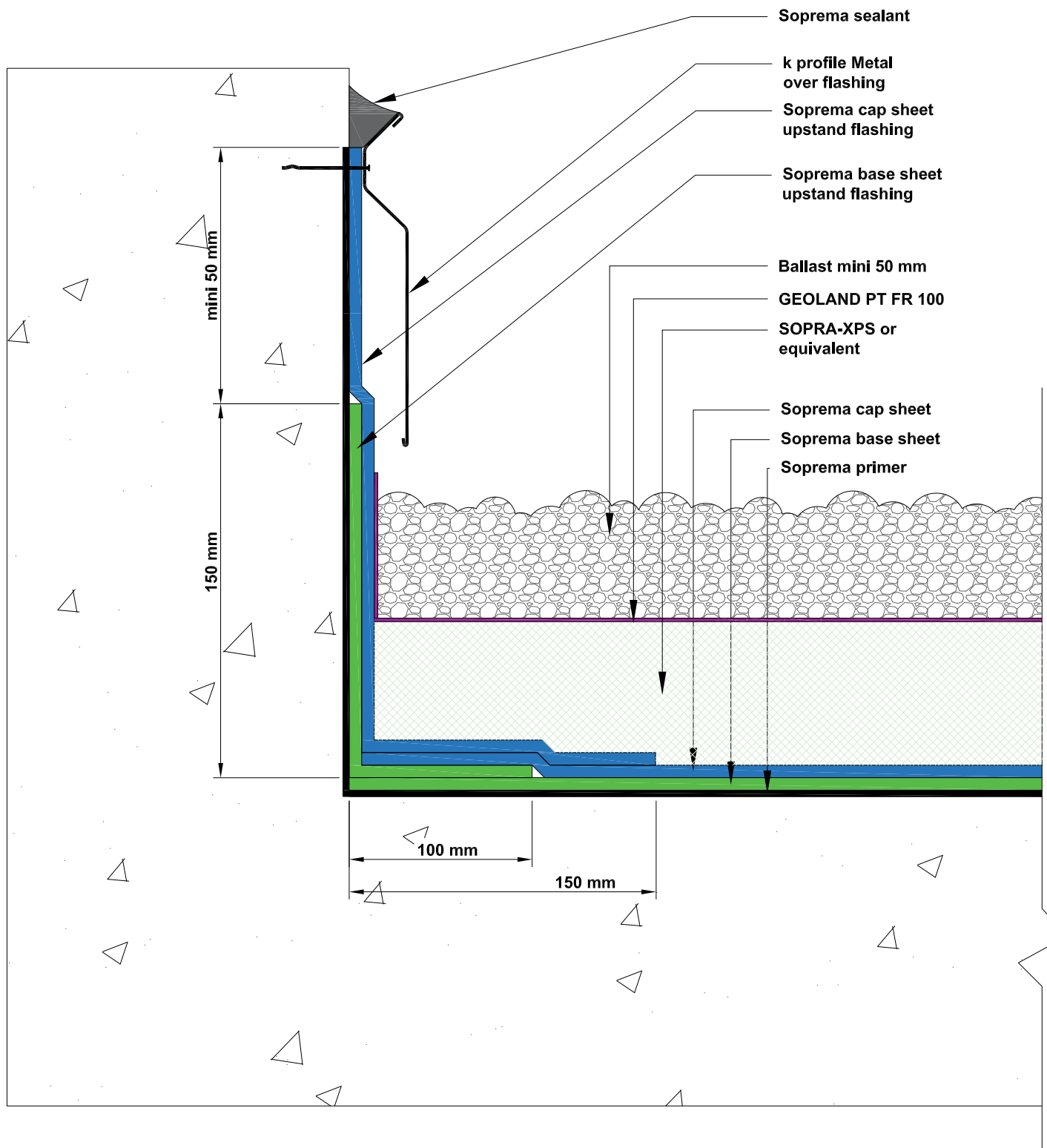

COPYRIGHT 2021 SOPREMA



LEVEL 35, BARANGAROO  
AVENUE, SYDNEY, 2000  
WWW.SOPREMA.COM.AU

TITLE: UP-STAND DETAIL WITH K PROFILE  
TERMINATION STRIP

|            |            |                            |
|------------|------------|----------------------------|
| PROJECT:   |            | DRAWING NUMBER:<br><br>IR7 |
| SCALE: NTS | DATE: 2021 |                            |

**NOTE:**

This detail is only indicative and should be verified by the designer and/or the applicator according to real job site conditions.

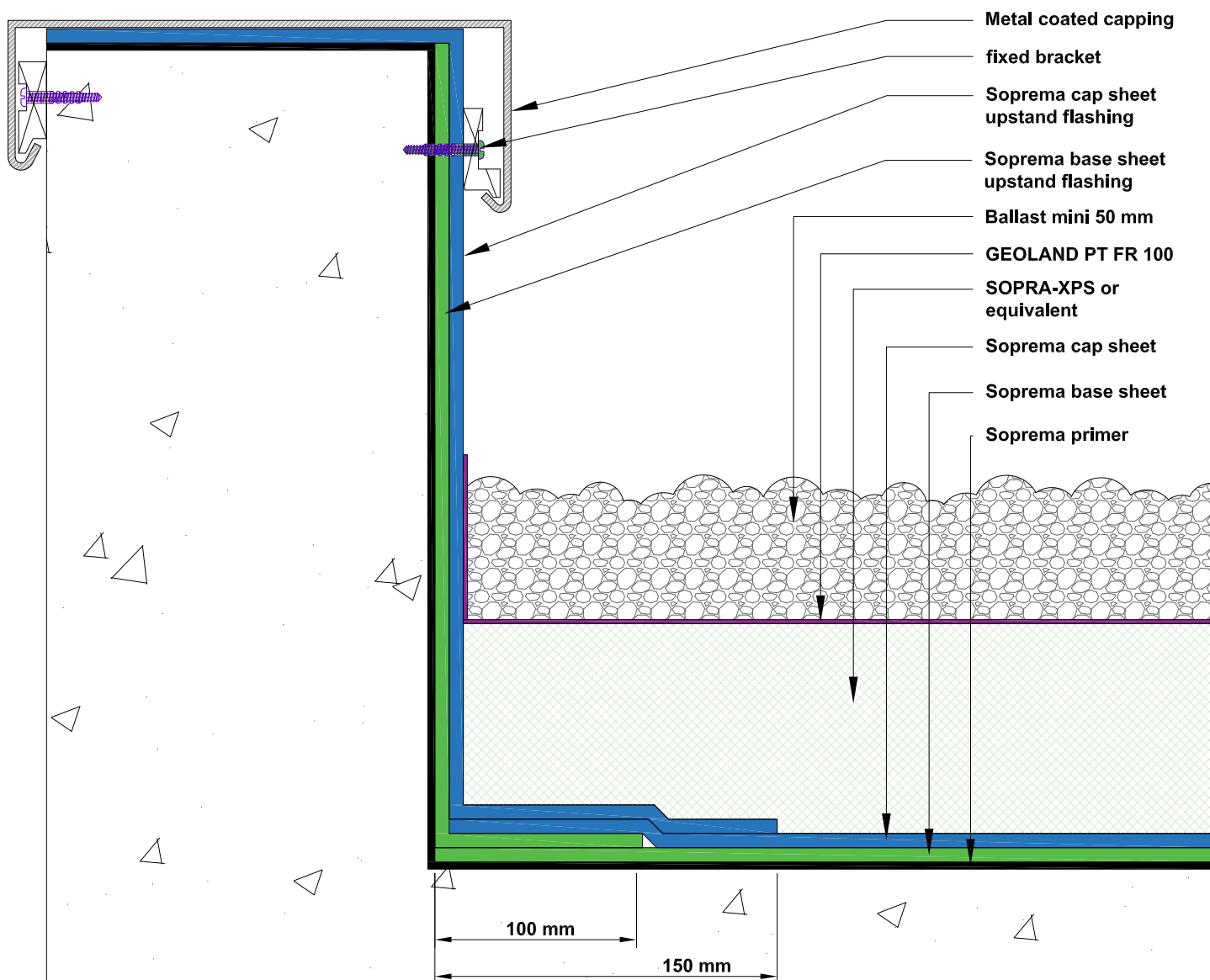

COPYRIGHT 2021 SOPREMA



LEVEL 35, BARANGAROO  
AVENUE, SYDNEY, 2000  
WWW.SOPREMA.COM.AU

TITLE: UP-STAND DETAIL WITH CAPPING  
TERMINATION

PROJECT:

DRAWING NUMBER:

SCALE:

NTS

DATE:

2021

IR8

**NOTE:**

This detail is only indicative and should be verified by the designer and/or the applicator according to real job site conditions.



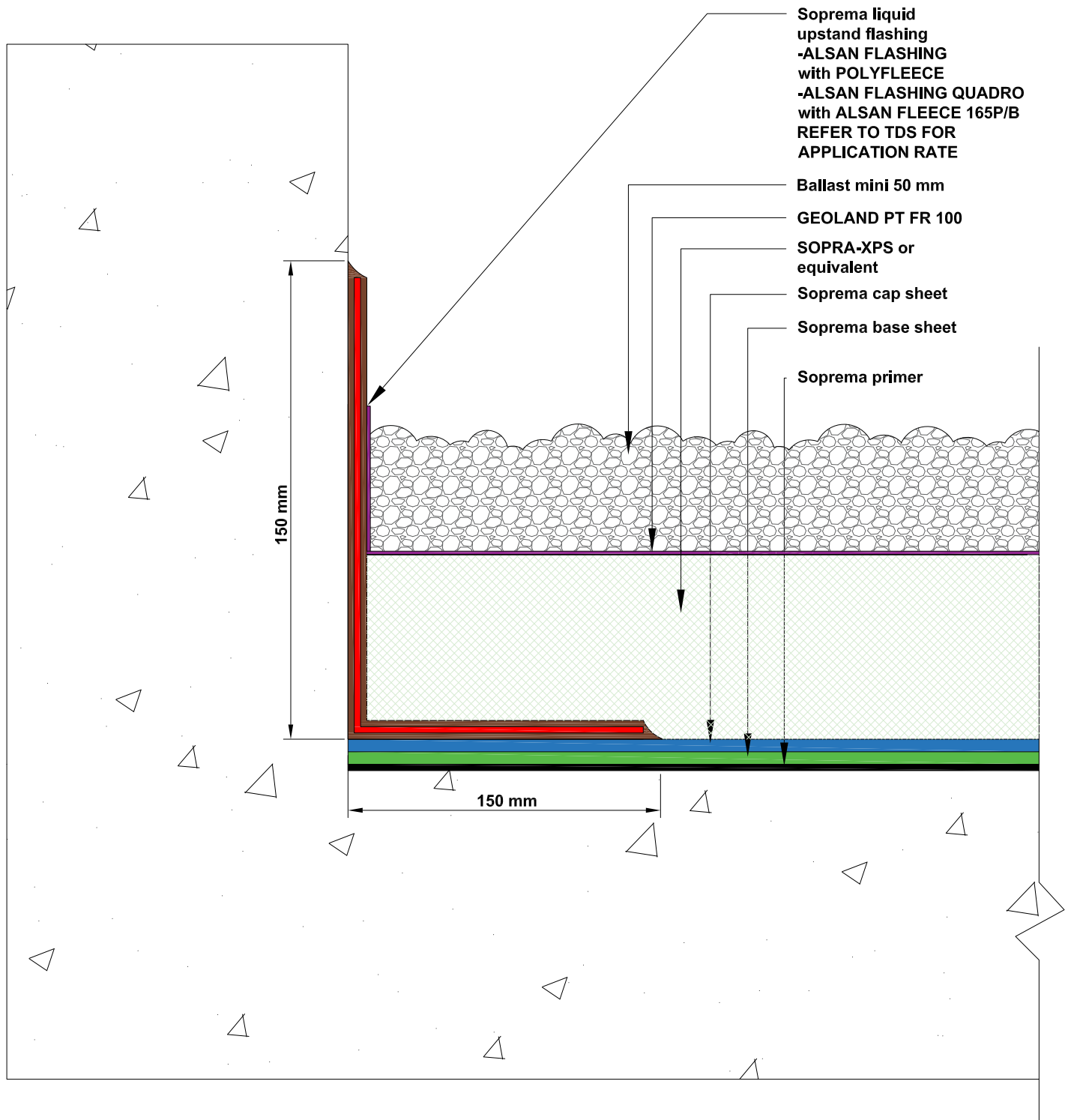

COPYRIGHT 2021 SOPREMA



LEVEL 35, BARANGAROO  
AVENUE, SYDNEY, 2000  
WWW.SOPREMA.COM.AU

TITLE: UP-STAND DETAIL WITH LIQUID  
TERMINATION

PROJECT:

DRAWING NUMBER:

SCALE:

NTS

DATE:

2021

IR9

**NOTE:**

This detail is only indicative and should be verified by the designer and/or the applicator according to real job site conditions.

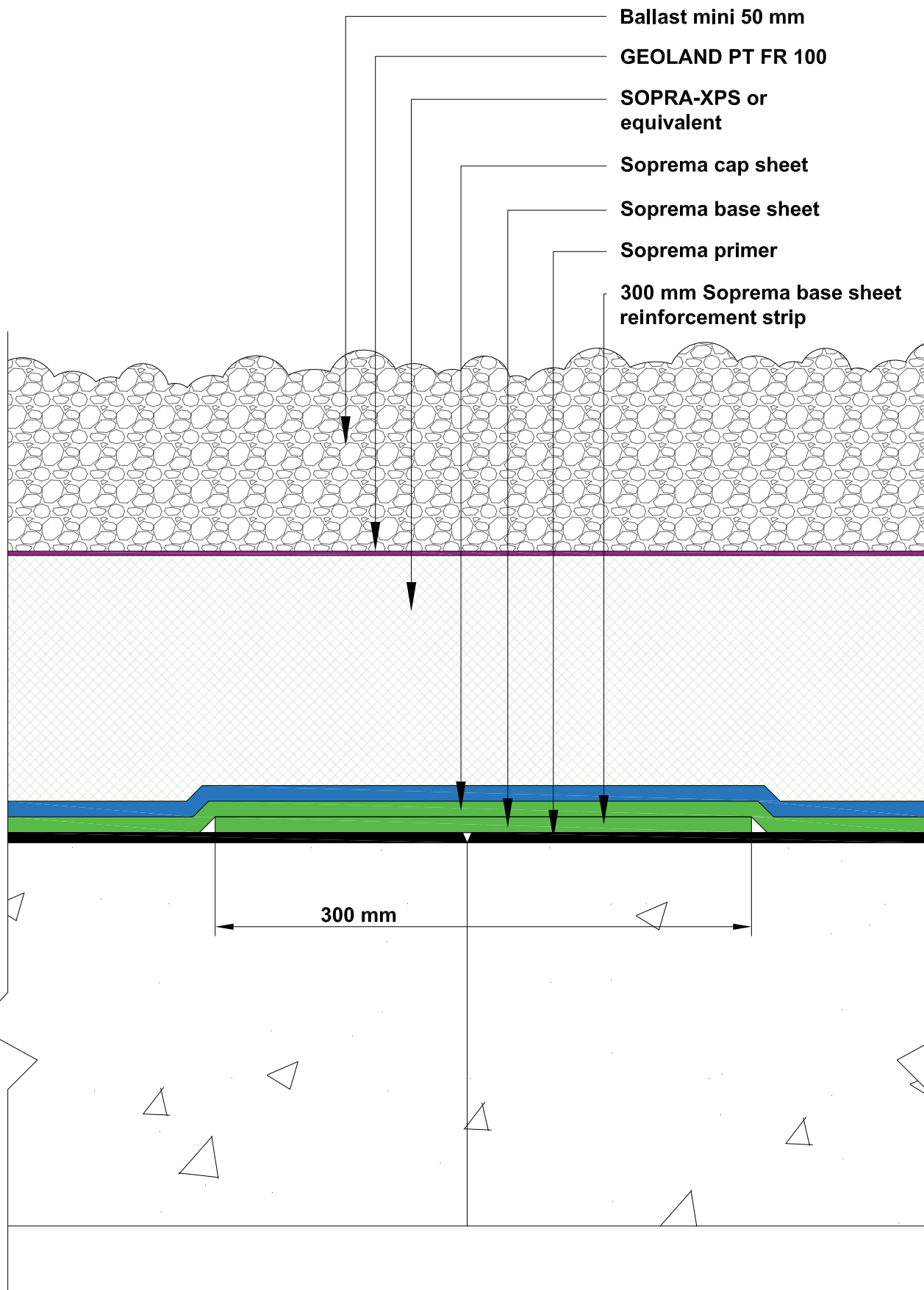

COPYRIGHT 2021 SOPREMA



LEVEL 35, BARANGAROO  
AVENUE, SYDNEY, 2000  
WWW.SOPREMA.COM.AU

TITLE: **CONSTRUCTION JOINT DETAIL**

PROJECT:

DRAWING NUMBER:

SCALE: **NTS**

DATE: **2021**

**IR13**

**NOTE:**

This detail is only indicative and should be verified by the designer and/or the applicator according to real job site conditions.



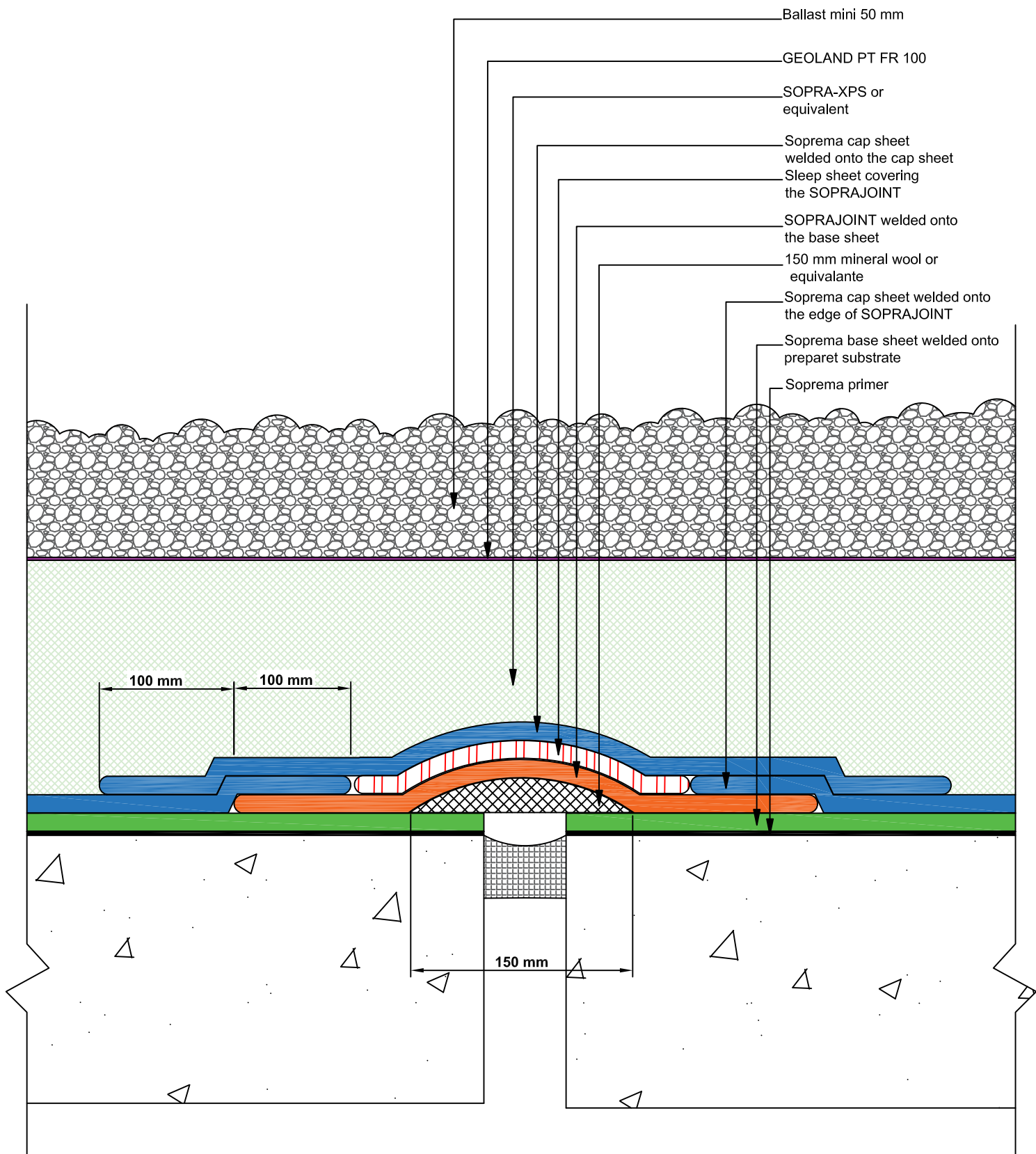

COPYRIGHT 2021 SOPREMA



**SOPREMA**

LEVEL 35, BARANGAROO  
AVENUE, SYDNEY, 2000  
WWW.SOPREMA.COM.AU

TITLE:

**MOVEMENT JOINT DETAIL  
WITH SOPRAJOINT**

PROJECT:

DRAWING NUMBER:

SCALE:

NTS

DATE:

2021

IR14

**NOTE:**

This detail is only indicative and should be verified by the designer and/or the applicator according to real job site conditions.

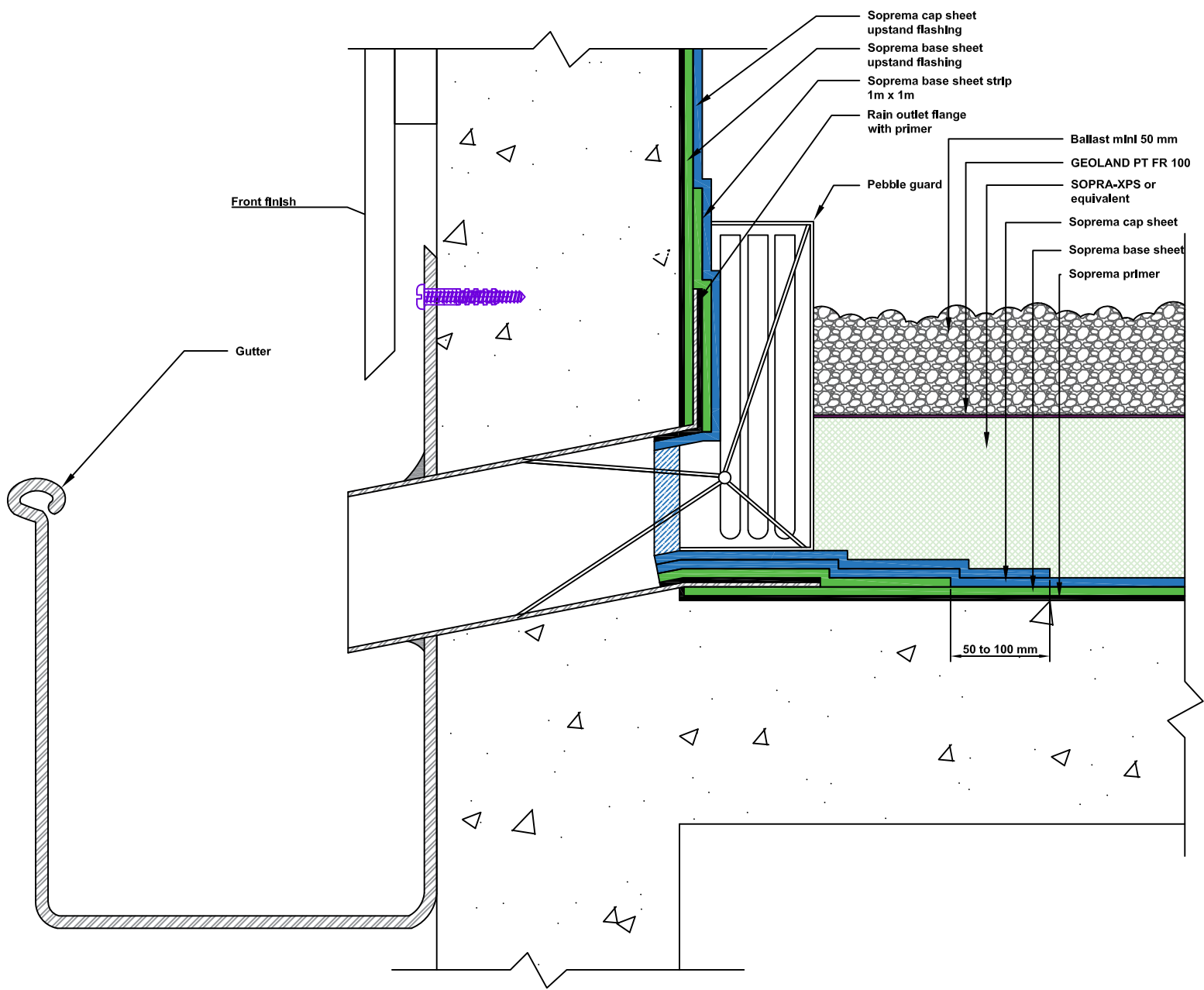

COPYRIGHT 2021 SOPREMA



**SOPREMA**

LEVEL 35, BARANGAROO  
AVENUE, SYDNEY, 2000  
WWW.SOPREMA.COM.AU

TITLE: WALL DRAIN ON BITUMEN MEMBRANE

PROJECT:

DRAWING NUMBER:

SCALE:

NTS

DATE:

2021

IR19

**NOTE:**  
This detail is only indicative and should be verified by the designer  
and/or the applicator according to real job site conditions.

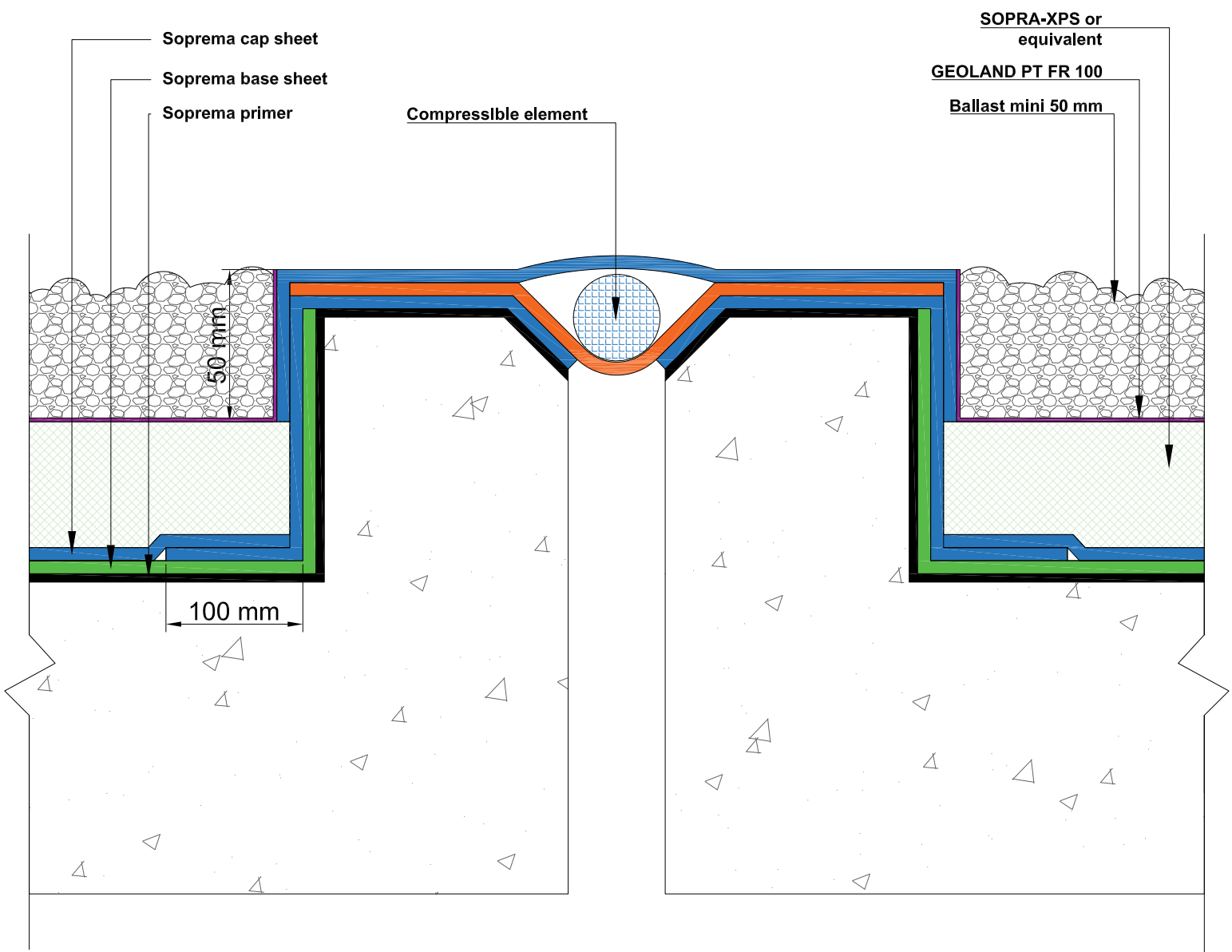

COPYRIGHT 2021 SOPREMA



LEVEL 35, BARANGAROO  
AVENUE, SYDNEY, 2000  
WWW.SOPREMA.COM.AU

TITLE: **MOVEMENT JOINT ONTO A HOB  
DETAIL**

PROJECT:

DRAWING NUMBER:

SCALE: **NTS**

DATE: **2021**

**IR20**

**NOTE:**

This detail is only indicative and should be verified by the designer and/or the applicator according to real job site conditions.

## SIDE LAPS

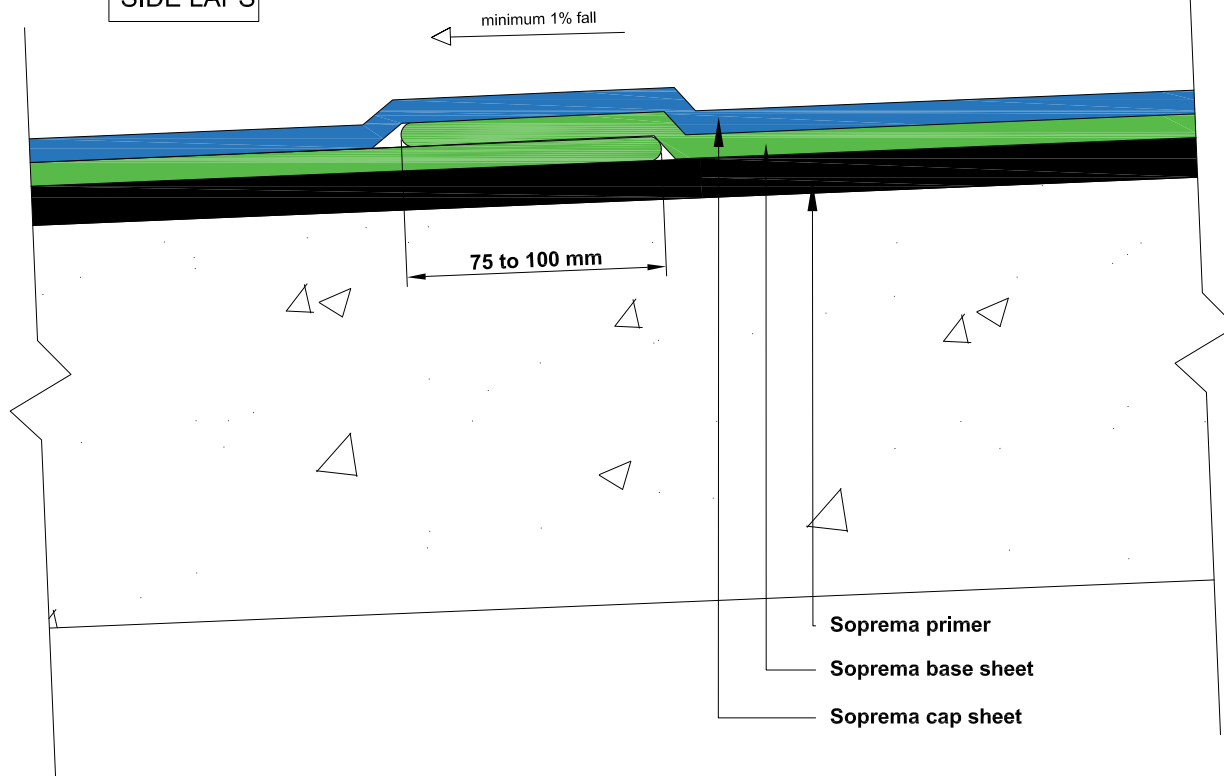

## END LAPS

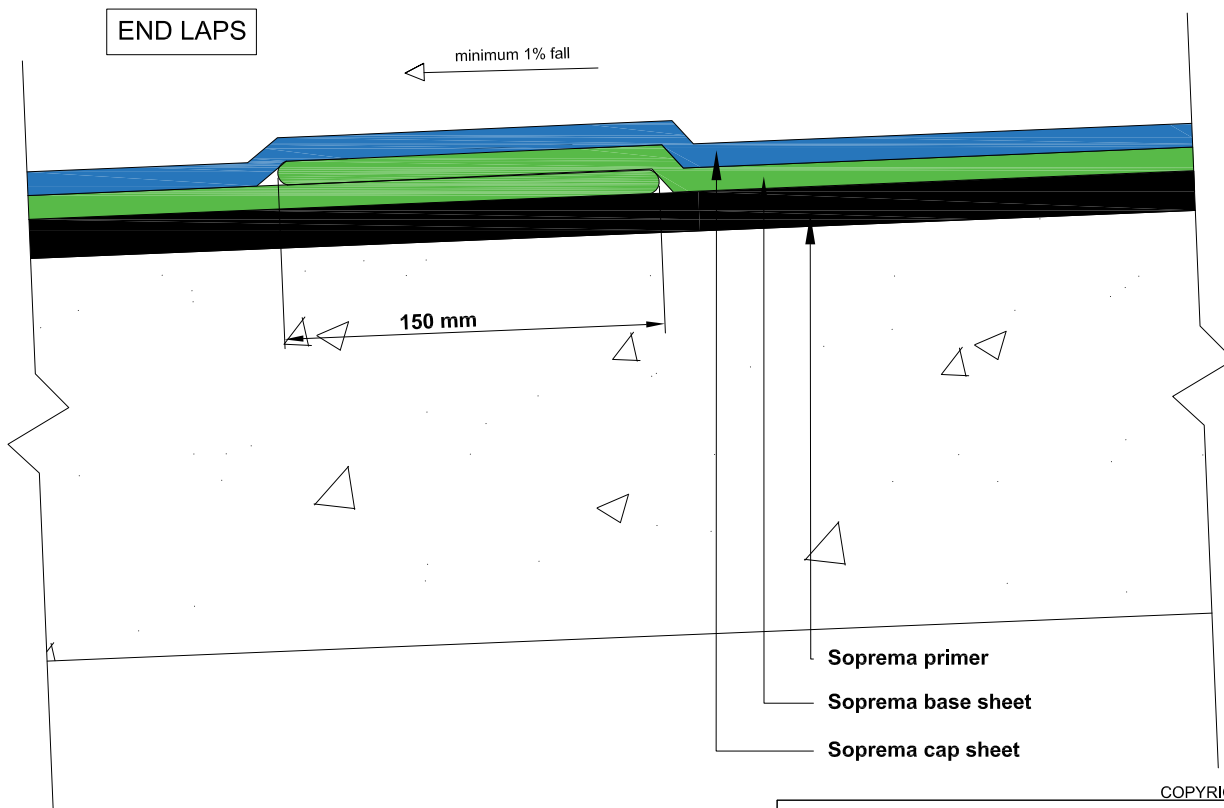

COPYRIGHT 2021 SOPREMA



LEVEL 35, BARANGAROO  
AVENUE, SYDNEY, 2000  
WWW.SOPREMA.COM.AU

TITLE: OVERLAP DETAIL

PROJECT:

DRAWING NUMBER:

SCALE: NTS

DATE: 2021

TO1

## NOTE

This detail is only indicative and should be verified by the designer and/or the applicator according to real job site conditions.

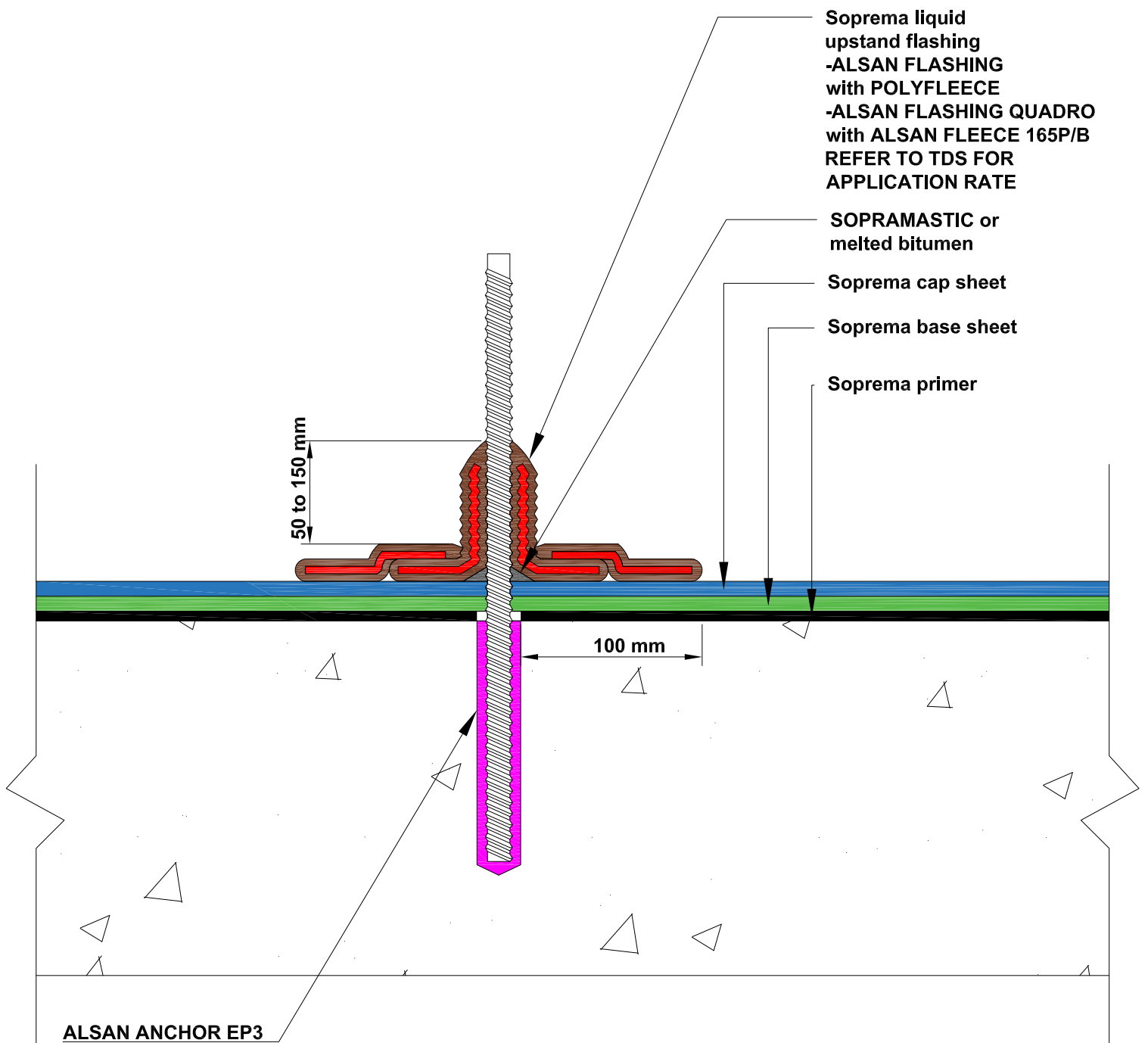

COPYRIGHT 2021 SOPREMA



LEVEL 35, BARANGAROO  
 AVENUE, SYDNEY, 2000  
 WWW.SOPREMA.COM.AU

TITLE: **DETAIL AT FIXINGS**

|          |     |                 |      |
|----------|-----|-----------------|------|
| PROJECT: |     | DRAWING NUMBER: |      |
| SCALE:   | NTS | DATE:           | 2021 |
|          |     | TO4             |      |

**NOTE**

This detail is only indicative and should be verified by the designer and/or the applicator according to real job site conditions.

CAP SHEET  
LAYOUT

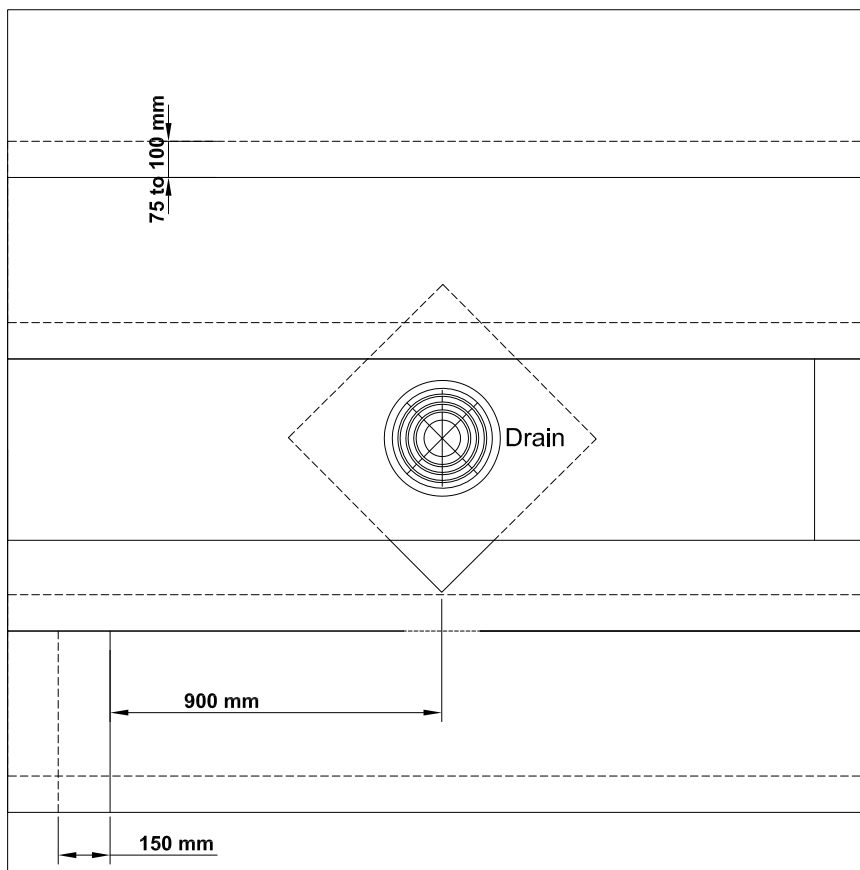

BASE SHEET  
LAYOUT

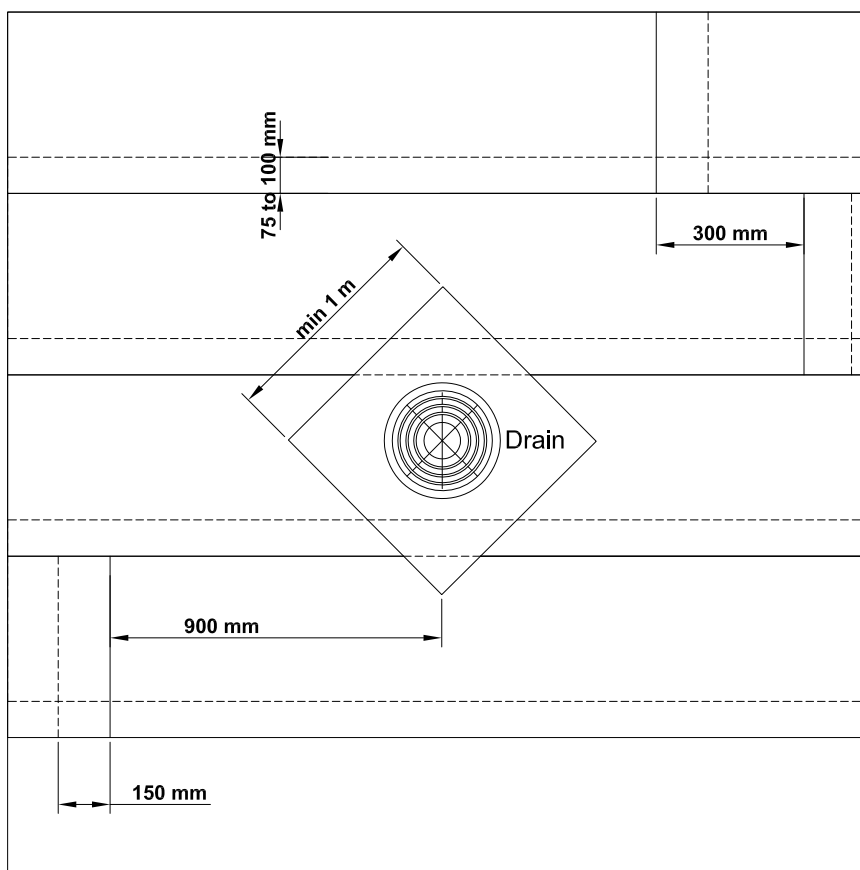

COPYRIGHT 2021 SOPREMA

**NOTE**

This detail is only indicative and should be verified by the designer and/or the applicator according to real job site conditions.



LEVEL 35, BARANGAROO  
AVENUE, SYDNEY, 2000  
WWW.SOPREMA.COM.AU

TITLE: MEMBRANE LAYOUT DETAIL

|          |     |       |                 |
|----------|-----|-------|-----------------|
| PROJECT: |     |       | DRAWING NUMBER: |
| SCALE:   | NTS | DATE: | 2021            |
|          |     |       | TO2             |



# INSULATION LAYOUT

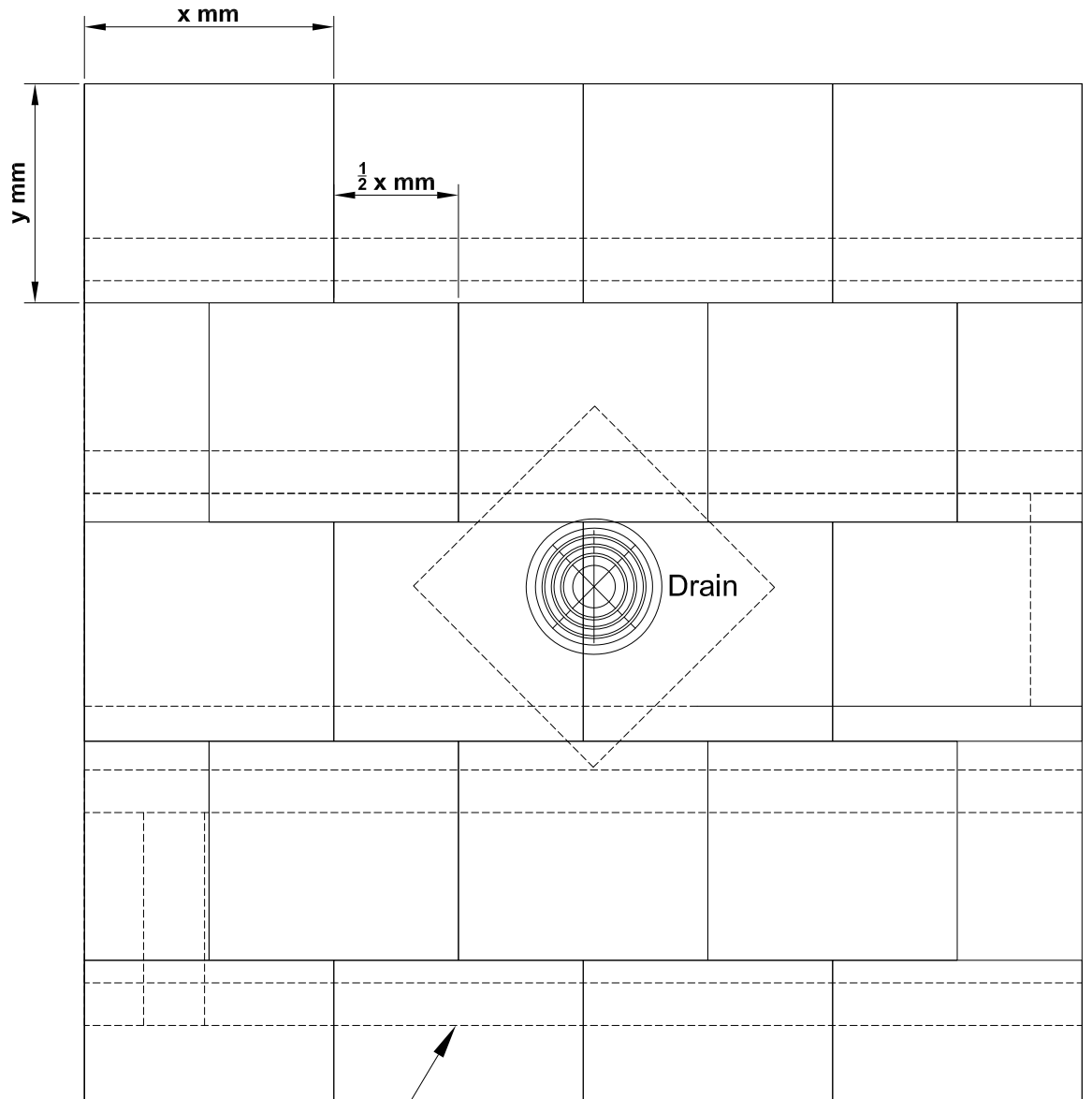

**Soprema vapor barrier or  
base sheet layout**

## NOTE:

This detail is only indicative and should be verified by the designer and/or the applicator according to real job site conditions.

COPYRIGHT 2021 SOPREMA



LEVEL 35, BARANGAROO  
AVENUE, SYDNEY, 2000  
WWW.SOPREMA.COM.AU

TITLE: **INSULATION LAYOUT DETAIL**

PROJECT:

DRAWING NUMBER:

SCALE: **NTS**

DATE: **2021**

**WR2**

SOPREMA's technical team will be more than happy to assist you with any queries you may have. Shall you have any questions, or need assistance with details review for your project, do not hesitate to contact us.

---

**Richard Ajavon**  
**Technical Manager**

[rajavon@soprema.com.au](mailto:rajavon@soprema.com.au)

