

# FLASHING TAPE

## WATERPROOFING MEMBRANE

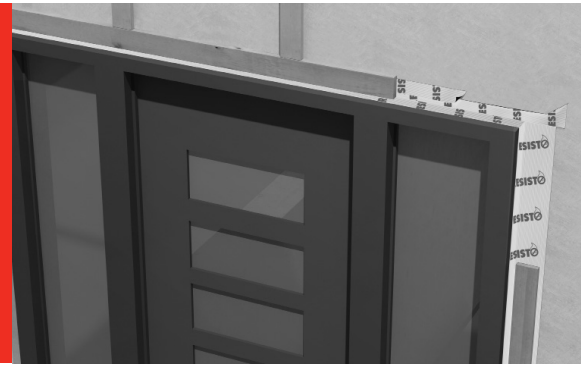

Self-adhesive bitumen membrane that eliminates drafts and water leaks by ensuring the continuity of air barrier and waterproofing systems around doors and windows. FLASHING TAPE must be covered by a finishing material.

- Provides a continuous air/water barrier
- Resists strong winds and gusts
- Eliminates drafts and water leaks

### PRODUCT ROLE

Application	Waterproofing	
Building Part	Doors & Windows Frames	
Substrate	Plywood	OSB
	Concrete	Gypsum

### PRODUCT CHARACTERISTICS

Technology	SBS modified bitumen
Surface	Polyethylene
Underface	Silicone paper release film
Installation Method	Self-adhering
Maximum exposure	90 days

### PACKAGING

Code	Width	Length	Thickness	Net Coverage	Quantity (pallet)
1005409	4 in	100 ft	25 mils	33.3 ft <sup>2</sup>	324
1005406	6 in			50 ft <sup>2</sup>	216
1005404	9 in			75 ft <sup>2</sup>	144
1005403	12 in			100 ft <sup>2</sup>	108
1005402*	18 in			150 ft <sup>2</sup>	72

\* On special order





### PROPERTIES

Tensile strength MD/XD	ASTM D1970	10 / 7.5 kN/m (57 /43 lbf/in)
Ultimate elongation, MD/XD	ASTM D1970	40 / 40%
Cold temperature flexibility	AAMA 711	Pass
Water vapor permeability	ASTM E96 (Procedure B)	<2.1 ng/Pa•s•m <sup>2</sup> (0.037 perm)

(All values are nominal)

## FLASHING TAPE

### INSTALLATION

Minimum Installation Temperature	50 ° F (10 ° C)		
Compatible Substrates	Over surfaces such as OSB, concrete, gypsum or fiberglass structural panels, use of EXTERIOR PRIMER or H <sub>2</sub> O PRIMER is strongly suggested.  FLASHING TAPE could usually be applied over a caulking bead such as polyurethane or butyl provided they are fully cured. It is recommended, however, to test it and ensure their compatibility prior to full application of the membrane.		
Complementary Product	EXTERIOR PRIMER	OR H <sub>2</sub> O PRIMER	
Tools required	 Membrane roller	 Measuring tape	
	 Utility knife	 Roller	
	 Brush		
Surface Preparation	The substrate should be clean, sound, dry and free of any loose materials, grease and contaminants that may compromise the performance of the product.		
Installation	<ol style="list-style-type: none"> <li>1. If necessary, apply EXTERIOR PRIMER or H<sub>2</sub>O PRIMER to the substrate.</li> <li>2. Apply the membrane on the substrate by removing the silicone paper release film.</li> <li>3. Once the membrane is in place , apply pressure over the entire surface with a hard roller to ensure perfect adhesion.</li> </ol> <p>Note: The membrane must overlap by at least 2 in.</p>		
Recommendations/ Restrictions	If the product is to be applied directly on wood planks, ensure that wood planks do not contain or are not surfaced with any substance, especially near the knots, that can liquefy bitumen. Otherwise, such area shall be covered. Must not be in contact with flexible PVC or other products containing plasticizers. In applications where the membrane could remain exposed for a longer time, use the ALUMINUM WATERPROOFING MEMBRANE. FLASHING TAPE is not designed for roof applications.		