



ACCESSORY PRODUCTS

APPLICATIONS

INDOOR APPLICATIONS

# SOPRA-CELLULOSE RULER

TECHNICAL DATA SHEET 191210SCANE

(supersedes 180110SCANE)

## DESCRIPTION

SOPRA-CELLULOSE RULER is a ruler for controlling the thickness of SOPRA-CELLULOSE insulation in the attic. It indicates the thickness to be applied in accordance with the thermal resistance of the insulation up to 60 for R value and 10.8 for RSI value.

## INSTALLATION

SOPRA-CELLULOSE RULER must be secured to roof trusses with the numbering of ruler facing the access hatch for easy readability. The bottom of the ruler must be installed at the same level as the bottom of the cellulose fiber to obtain the proper applied values. Apply 1 ruler per 18,5 m<sup>2</sup> (200 ft<sup>2</sup>).

FOR COMPLETE INFORMATION ON PRODUCT INSTALLATION, PLEASE CONSULT YOUR REPRESENTATIVE.

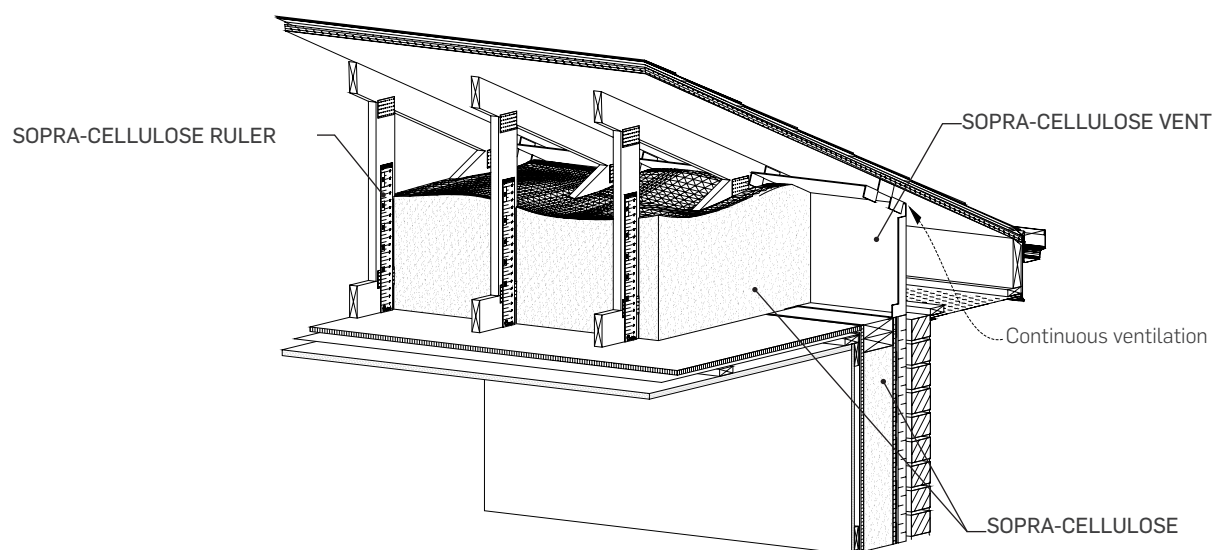

## PACKAGING

Specifications	SOPRA-CELLULOSE RULER
Dimension	53.3 cm x 5.1 cm (21 in X 2 in)
Qty/Package	50 units
Weight	0,45 kg/package (0.99 lb/package)



SOPREMA.US • 1.800.356.3521

SOPREMA.CA • 1.877.MAMMOUTH

NOTE: SOPREMA INC. may modify the composition and/or utilization of its products without prior notice.

TDS\_SOPRA\_CELLULOSE\_RULER.indd