

SOPRASEAL® STICK AVB AT



WATERPROOFING



SELF-ADHESIVE AIR AND VAPOUR BARRIER MEMBRANE

The SOPRASEAL STICK AVB AT membrane is composed of an acrylic mass and a tri-laminated woven polyethylene on the surface. It is used as a through-wall membrane, a transition membrane, and a waterproofing membrane at the perimeter of openings.

ADVANTAGES

- Superior adhesion in a **wide range of temperatures** from **-18 °C à 45 °C (0 °F à 113 °F)**
- **No primer needed**, allowing for quick installation
- **The maximum adhesive strength is reached within 12 to 24 hours.** During the installation process, the membrane is easy to handle thanks to its initial adhesive properties.
- Meets Canadian air barrier requirements **CAN/ULC-S741** and **CAN/ULC-S742.**
- Thin tape which **eliminates excess thickness** and keeps the opening of the frame clear to facilitate the insertion of a window or door
- **Easy installation** thanks to the split-back release silicone film
- **Self-sealing properties** around nails, screws and fasteners
- **UV resistant for 90 days**



SIZES AVAILABLE

Description	Product Code	Length	Rolls/Box	Boxes/Pallet	Rolls/Pallet
Sopraseal Stick AVB AT 10 cm (4 in)	24798	22.9 m (75 ft)	12	36	432
Sopraseal Stick AVB AT 15 cm (6 in)	24799	22.9 m (75 ft)	8	36	288
Sopraseal Stick AVB AT 23 cm (9 in)	24800	22.9 m (75 ft)	4	48	192
Sopraseal Stick AVB AT 30 cm (12 in)	24801	22.9 m (75 ft)	4	36	144
Sopraseal Stick AVB AT 45.7 cm (18 in)	24802	22.9 m (75 ft)	2	48	96
Sopraseal Stick AVB AT 91.5 cm (36 in)	24797	22.9 m (75 ft)	N/A	N/A	45



SOPRASEAL STICK AVB AT

INSTALLATION GUIDE

1



Insert the corner guards on the weather barrier to prevent infiltration.
Mechanically secure the **CORNER GUARDS**.

2



Apply the **SOPRASEAL STICK AVB AT** membrane on the lower part of the window and cover 5 cm to 7.5 cm (2 in to 3 in) of the weather barrier.
Cut the membrane on each side of the opening and adhere it with a membrane roller.

3



Install a membrane strip from 2 to 3 in (5 to 7.5 in) on the weather barrier.

4



Lift the upper weather barrier.
Adhere the **SOPRASEAL STICK AVB AT** membrane to cover the top of the window.

5

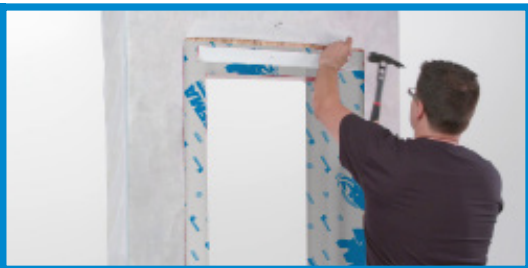

Installer le solin métallique selon le code du bâtiment.

6

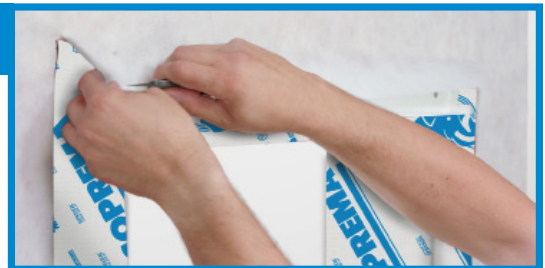

Fold the weather barrier membrane in place.
Cut 1 in (2.5 cm) of the weather barrier to clear the metal flashing.

7



Seal the corners of the metal flashing with the **SOPRASEAL STICK AVB AT** membrane diagonally at each end.

8



Apply pressure on the membrane using a hard roller for stronger adhesion.